



FOR YOUTH DEVELOPMENT®
FOR HEALTHY LIVING
FOR SOCIAL RESPONSIBILITY

A GUIDE TO YOUR HOME AWAY FROM HOME

Fairview Lake YMCA Camps



fairviewlakeymca.org

WHERE YOU'LL STAY

YEAR-ROUND UNITS

Fairview Lake YMCA Camps has three winterized cabin units and a large lodge available for groups. They are separated by wooded areas permitting simultaneous use by several small groups, or your group can rent out the entire unit or the whole side of camp!

The buildings are duplex in style. Each side of a building is identified by a cabin number (listed below). Each cabin has 10-12 built in bunks and its own indoor bathroom. Due to the design of the buildings, coed groups can be easily accommodated. The cabins have heat, electric lights and outlets. Smoke detectors and fire extinguishers are standard in each cabin.

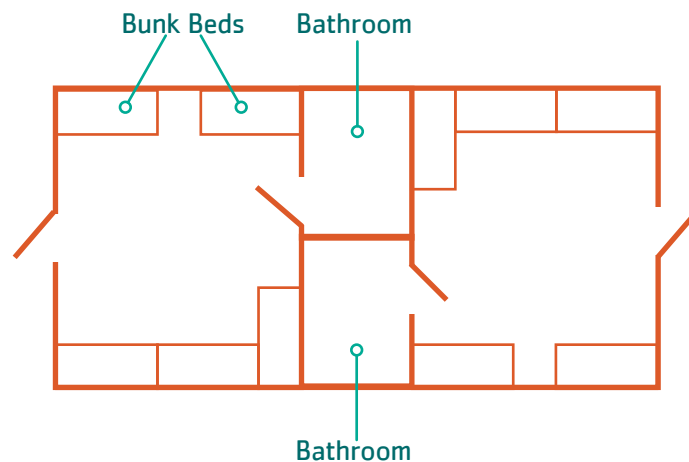

Birch

Cabins #1-6 Capacity: 64
Hudson/Edison Capacity: 20

Laurel Ridge

Cabins #7-14 Capacity: 80

Lakeside

Cabins #15-24 Capacity: 104



Wickapecck

Wickapecck is a unique lodge located near the entrance to camp. The converted farmhouse has bedrooms and bathrooms on two floors, plus a dorm-style wing. A snack kitchen (refrigerator, stove, sink; no kitchen ware), porch and living room make this a great place for large groups and families. Capacity is 50.

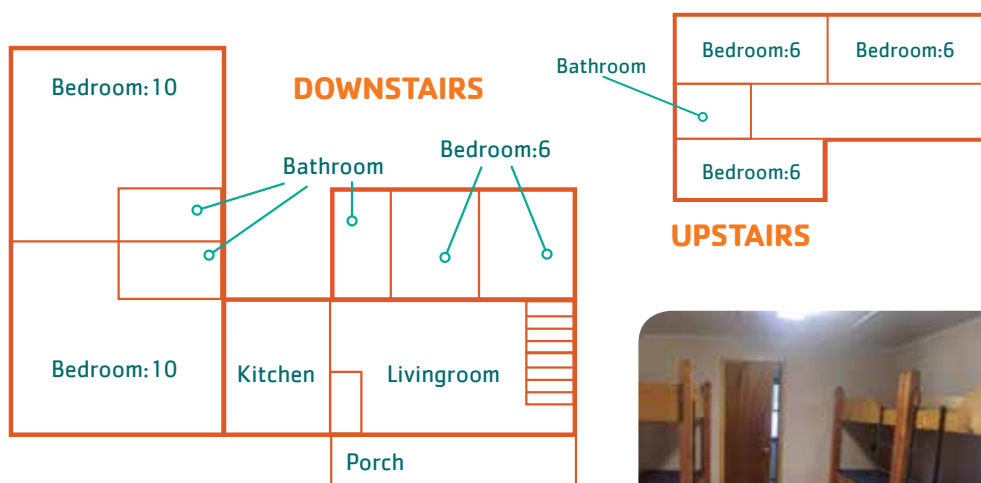

SEASONAL UNITS

Fairview Lake YMCA Camps has three seasonal cabin units available for groups. Seasonal cabins are open in the Spring, Summer and Fall only. Each unit has its own bathhouse with electrical outlets. Each unit also has its own fire pit for camp fires and cooking. We also have room for tent camping.

Delaware

Nine cabins nestled on the hillside, each with eight built-in bunks. Delaware has a pavilion area with picnic tables and is near a large athletic field. Cabin capacity is 72 people; tenting is also possible.

Wakigan

Ten Adirondack shelters with two bunk beds each accommodate four people. The unit features its own waterfront, which must be staffed by Fairview Lake lifeguards for use. Cabin capacity is 40 people; tenting is also possible.

Warrior

Six cabins, each with eight built-in bunks. A basketball court, Kittatinny Program Lodge and the Wakigan waterfront are a short walk away. Cabin capacity is 48 people; not suitable for tenting.



WHERE YOU'LL PLAY

Groups in need of places to meet have many options while at camp. From outdoor amphitheaters to large capacity lodges, our directors will assign your group a space to best suit your needs.

Meeting Spaces

Groups may use the CIT Center (capacity: 50), the lower level of the Hudson-Edison cabin (capacity: 40), the Dining Hall or the Nature Lodge (capacity: 30) for meetings and break-out sessions.

Outdoor Amphitheaters

White Oak Chapel: Stage area and outdoor seating for 300.

Lakeside Fire Ring: Fire ring and outdoor seating for 300.



Nature Lodge

Program Lodges

Kittatinny Lodge: With a large fireplace and main room, plus great spaces for smaller meetings and activities, Kittatinny provides a warm and friendly space for your group.

Minisink Lodge: Minisink is a state of the art program building. Multiple break out rooms, an indoor climbing wall, our cross country ski shop, a stage, candle making room, and a great room with a grand fireplace.



Kittatinny Lodge



Dining Hall



Minisink Lodge

PROGRAM OPTIONS

While at camp, your group has many options for their activities. Some groups make use of the meeting spaces and facilitate their own programs, while other groups utilize our staff for programming. Whichever option your group decides on, we are happy to help you make the most out of your stay

CAMP PROGRAMS

Our staff can facilitate programming and activities at no extra charge. Scheduling of certain programs is weather dependent, and alternative programs may be necessary in certain circumstances.

Apple Cidering*

Archery

ASE (Team Building)

Basketball

Boating*

Campfire Program

Candle Making

Climbing (indoor & outdoor)

Colonial Cooking

Cooperative Games

Cross Country Skiing*

Fishing

Giant Swing

Hiking

Ice Fishing*

Night Hike

Orienteering/GPS

Off-Site Hikes

Pontoon Boat Rides*

Riflery & BBs

Sledding*

Softball

Survival Skills

Star Lab

Stream Exploration

Swimming*

Swamp Walk

Snow Sculpture*

Ridge Hike

Tennis

Tye-Dye

Volleyball

Wildlife Study

*Seasonal Program



Winter Ridge Hike

LOOKING FOR MORE ADVENTURE?

These add-on activities are a great option for groups big and small!

High Ropes

Zip Line

Leap of Faith

Vertical Play Pen



Giant Swing

WHAT YOU'LL EAT

Hot, nutritional, family-friendly meals will keep you energized during your stay at camp! Meals in our dining hall can be served family style, or buffet style, depending on the needs and size of your group. We can also provide evening snacks like big chocolate chip cookies and milk, an ice cream social or s'mores around the campfire!

OPTIONS & SPECIAL REQUESTS For guests with special dietary needs, we can provide a range of options. Please contact us to discuss your menu needs. We do not serve peanuts or peanut products in our dining hall.

BIRTHDAYS & CELEBRATIONS Will someone in your group be celebrating a birthday or milestone? Please let us know so we can celebrate camp style!

SAMPLE MENU:

ALL DAY	Breakfast	Lunch	Dinner
Fresh Fruit Coffee Tea Water	Assorted Cereal Scrambled Eggs Sausage Links French Toast Sticks Oatmeal Breakfast Bar Orange Juice Water Coffee Tea Milk	TACO BAR Hard & Soft Tortillas Seasoned Beef Chipotle Chicken Mexican Rice Refried Beans Corn Tortilla Chips con queso Salsa, Sour Cream, Guacamole Cookies/Fresh Fruit Salad Bar Juice Coffee Tea Water	THANKSGIVING Turkey Stuffing Gravy Cranberry Sauce Dinner Rolls Mixed Veggies Mashed Potatoes Gravy Home-Made Brownies Salad Bar Milk Coffee Tea Water

MEET OUR STAFF

PROGRAM STAFF

Our experienced staff are chosen for their ability to relate to a variety of age groups, their enthusiasm and their spirit. Staff are available for many activities and programs to make your time at camp memorable and enjoyable. A background check is conducted on each employee to ensure the safety of all of our guests.

GROUP HOST

Each group is assigned a host, one of our staff members who's job is to make sure you are getting the most out of your stay. They will help to adjust your schedule for rainy days, make sure the lights are on in your meeting space, and can answer questions you might have about camp.

FREQUENTLY ASKED QUESTIONS

Campfire at Lakeside
Fire Ring



Are fires allowed in the units? We ask that guests use the fire rings and provided firewood, located near the units, for campfire needs. Campfires must be coordinated with Fairview Lake YMCA staff.

Are pets allowed at camp? Only certified service animals are allowed at camp, and animals may not be left unattended at any time.

Outdoor Climbing



Can I cook my own food at camp? Guests staying in our seasonal units may cook their own food.

Can you accommodate wheelchairs? Camp roads are gravel, and paths can be uneven, so we recommend borrowing one of our all-terrain wheelchairs when at camp. Hudson and Edison cabins are accessible. Please contact us with accessibility needs so we can best serve you.

Is there internet at camp? Several of our buildings have limited wifi available for use, however, we encourage all of our guests to use their time at camp to unplug and unwind!

Archery at the Wilson
Archery Range

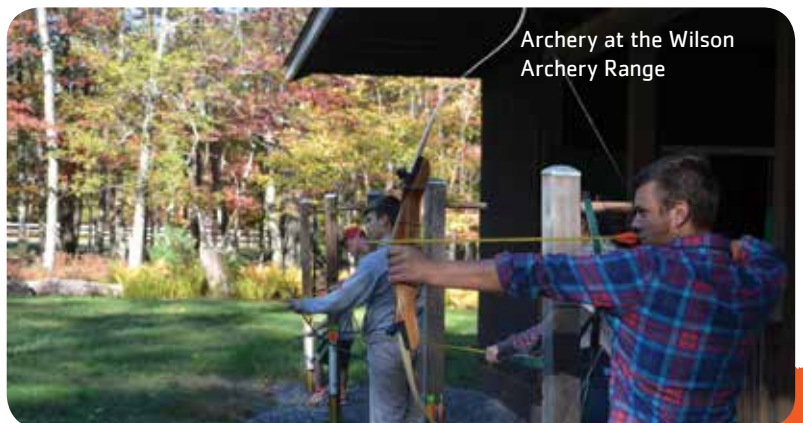



FAIRVIEW LAKE YMCA CAMPS
1035 Fairview Lake Road
Newton, NJ 07860

Want to see for yourself? Schedule a personalized tour of our facilities today!
800.686.1166



**CHARITY
NAVIGATOR**
★★★★★
Four Star Charity

The YMCA
is a 501(c)3
non-profit
organization.

fairviewlakeymca.org